

I hereby certify that this plan, specification, or report was prepared by me or under my direct supervision and that I am a duly licensed architect under the laws of the State of Minnesota.

Signature _____
Typed or Printed Name _____
License # Date _____

NOT FOR CONSTRUCTION

PUD APPLICATION
- SEP 07 2021

ORIGINAL ISSUE:
09/07/21

REVISIONS:
No. Description Date

5065.0000
PROJECT NUMBER

SAC DRAWN BY JJA
CHECKED BY

KEY PLAN

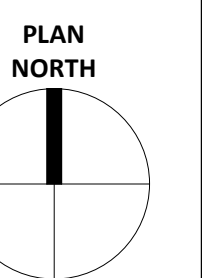

9920 Wayzata Blvd

PHOTOMETRIC SITE PLAN
E0.2

LIGHT FIXTURE SCHEDULE

GENERAL NOTES							
A. CATALOG NUMBERS INDICATES BASIC FIXTURE TYPE REQUIRED FOR THIS PROJECT AND MAY NOT BE COMPLETE. VERIFY WITH MANUFACTURER TO INCLUDE ALL OPTIONS AND ACCESSORIES REQUIRED FOR THIS INSTALLATION.							
B. ELECTRICAL CONTRACTOR SHALL BE RESPONSIBLE FOR VERIFYING FIXTURE LOCATIONS, MOUNTING, AND REQUIREMENTS WITH ARCHITECTURAL PLANS, SECTIONS, ELEVATIONS, AND REFLECTED CEILING PLANS PRIOR TO ORDERING FIXTURES.							
C. ALL FINISHES SHALL BE VERIFIED WITH THE ARCHITECT PRIOR TO ORDERING FIXTURES. FINISH SELECTION TO BE FROM MANUFACTURERS STANDARD FINISHES UNLESS NOTED OTHERWISE. FINISHES SHALL BE VERIFIED AT THE TIME OF SHOP DRAWING SUBMITTAL.							
D. SEE SPECIFICATIONS FOR EXTRA MATERIALS REQUIRED FOR LIGHT FIXTURES.							
E. SAMPLES OF ALL FIXTURES SHALL BE AVAILABLE AT THE ENGINEER'S REQUEST DURING SHOP DRAWING REVIEW.							
F. COORDINATE THE COMPATIBILITY OF DIMMING WITH SPECIFIED CONTROLS. DIMMING SHALL BE ACCOMPLISHED WITH NO VISIBLE FLICKER.							
FIXTURE NOTES							
1. COORDINATE POLE HEIGHT AND CONCRETE BASE.							
TYPE	DESCRIPTION	VOLT	LAMPS TYPE	VA FIXT.	MANUFACTURER	CATALOG NUMBER	NOTES
B1	BOLLARD, 42" HEIGHT, 1" ROUND, EXTRUDED ALUMINUM, 300mA DRIVE CURRENT, ASYMMETRIC DISTRIBUTION, 0-10V DIMMING, FINISH BY ARCHITECT	UNV	LED, 1194 LUMENS, 3000K, 70 CRI	16	LITHONIA	DSXB12C3000KAS7MVC0.T0M0XXXX	
D1	DOWNLIGHT, 4" ROUND, SALVAGED STEEL, CLEAR REFLECTOR AND FLANGE, MEDIUM WIDE DISTRIBUTION, SEMI-SPECULAR FINISH, WET LOCATION, 0-10V DIMMING	UNV	LED, 1000 LUMENS, 3000K, 85 CRI	9	GOTHAM	EV0403D1000MELSSR0VOLTZ010	
P1	EXTERIOR LIGHT POLE AND LED AREA LUMINAIRE, DIE-CAST ALUMINUM HOUSING, ACRYLIC LENS, 4" STRAIGHT SQUARE STEEL POLE WITH BASE COVER, TYPE 4 FORWARD THROW DISTRIBUTION, 2 SQUARES, 1200mA DRIVE CURRENT, SINGLE HEAD, 20' TOTAL HEIGHT, INTEGRAL PHOTOCELL AND OCCUPANCY SENSOR, FINISH BY ARCHITECT	UNV	LED, 16970 LUMENS, 3000K, 70 CRI	129	LITHONIA	GLEONSAD720UT4FTX08PCMSIDM4L20	1
P2	EXTERIOR LIGHT POLE AND LED AREA LUMINAIRE, DIE-CAST ALUMINUM HOUSING, ACRYLIC LENS, 4" STRAIGHT SQUARE STEEL POLE WITH BASE COVER, TYPE 4 FORWARD THROW DISTRIBUTION, HOUSE-SIDE SHIELD, 2 SQUARES, 1200mA DRIVE CURRENT, SINGLE HEAD, 20' TOTAL HEIGHT, INTEGRAL PHOTOCELL AND OCCUPANCY SENSOR, FINISH BY ARCHITECT	UNV	LED, 16970 LUMENS, 3000K, 70 CRI	129	LITHONIA	GLEONSAD720UT4FTX08PCMSIDM4L20	1
P3	EXTERIOR LIGHT POLE AND LED AREA LUMINAIRE, DIE-CAST ALUMINUM HOUSING, ACRYLIC LENS, 4" STRAIGHT SQUARE STEEL POLE WITH BASE COVER, TYPE 4 WIDE DISTRIBUTION, 4 SQUARES, 1200mA DRIVE CURRENT, SINGLE HEAD, 20' TOTAL HEIGHT, INTEGRAL PHOTOCELL AND OCCUPANCY SENSOR, FINISH BY ARCHITECT	UNV	LED, 31080 LUMENS, 3000K, 70 CRI	258	LITHONIA	GLEONSAD720UT4W08PCMSIDM4L20	1
P4	EXTERIOR LIGHT POLE AND LED AREA LUMINAIRE, DIE-CAST ALUMINUM HOUSING, ACRYLIC LENS, 4" STRAIGHT SQUARE STEEL POLE WITH BASE COVER, TYPE 2 DISTRIBUTION, 2 SQUARES, 1200mA DRIVE CURRENT, SINGLE HEAD, 20' TOTAL HEIGHT, INTEGRAL PHOTOCELL AND OCCUPANCY SENSOR, FINISH BY ARCHITECT	UNV	LED, 15580 LUMENS, 3000K, 70 CRI	129	LITHONIA	GLEONSAD720UT208PCMSIDM4L20	1
W1	WALL SCONCE, ARCHITECTURAL, DIE-CAST ALUMINUM, FORWARD THROW DISTRIBUTION, WET LOCATION, 0-10V DIMMING, FINISH BY ARCHITECT	UNV	LED, 1500 LUMENS, 3000K, 70 CRI	12	LITHONIA	WSTLEP130KYFMV0LDM0XXXX	
W2	WALL SCONCE, ARCHITECTURAL, DIE-CAST ALUMINUM, WIDE DISTRIBUTION, WET LOCATION, 0-10V DIMMING, FINISH BY ARCHITECT	UNV	LED, 1500 LUMENS, 3000K, 70 CRI	12	LITHONIA	WSTLEP130KYVMV0LDM0XXXX	
W3	WALL PACK, DIE-CAST ALUMINUM, IMPACT-RESISTANT GLASS, FULL CUTOFF, WET LOCATION, 0-10V DIMMING, FINISH BY ARCHITECT	UNV	LED, 1337 LUMENS, 3000K, 70 CRI	12	COOPER	1XCR18P0XX	

Calculation Summary	CalcType	Units	Avg	Max	Min
EAST PROP LINE	Illuminance	Fc	0.45	1.0	0.0
NORTH PROP LINE	Illuminance	Fc	0.45	0.9	0.0
SITE	Illuminance	Fc	2.78	15.3	0.0
SOUTH PROP LINE	Illuminance	Fc	0.35	0.9	0.0
WEST PROP LINE	Illuminance	Fc	0.39	0.6	0.0

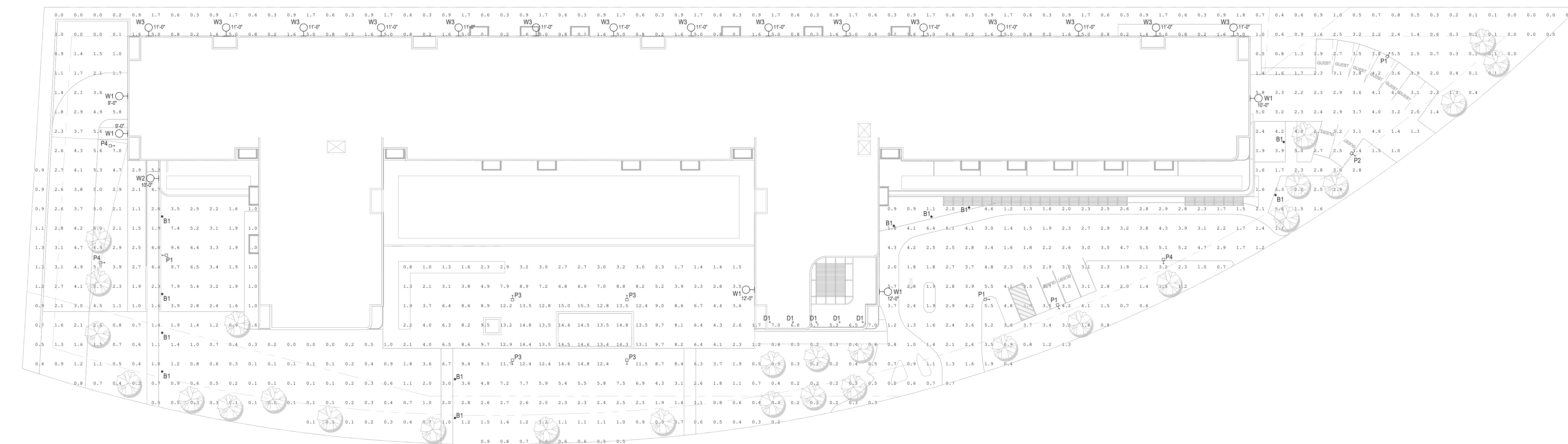

1 PHOTOMETRIC SITE PLAN
SCALE: 1" = 30'-0"