

**PAVING NOTES:**

1. CONTRACTOR SHALL FOLLOW ALL CITY OF ST. LOUIS PARK STANDARDS AND SPECIFICATIONS.
2. ALL CURB AND GUTTER IS TO BE B612 CONCRETE CURB AND GUTTER UNLESS NOTED OTHERWISE.
3. REFER TO ARCHITECTURAL PLANS FOR BUILDING.
4. FOLLOW ALL CITY OF ST. LOUIS PARK RULES, REGULATIONS, AND SPECIFICATIONS WHEN WORKING IN PUBLIC RIGHT OF WAY.
5. STRIPE PARKING LOT AS SHOWN, ALL PARKING STALLS ARE TO BE 8.5 FEET WIDE BY 18 FEET LONG, UNLESS NOTED OTHERWISE.
6. THE CONTRACTOR IS TO CONTACT THE CITY OF ST. LOUIS PARK FIRE MARSHALL FOR THE EXACT PLACEMENT OF FIRE LANES, YELLOW-PAINTED CURBING, AND NO PARKING AREAS FOR FIRE PROTECTION PURPOSES.
7. REFER TO STRUCTURAL PLANS FOR STOOP DETAILS. ALL WALKS ARE TO BE CENTERED ON THE DOORS.
8. INSTALL APPROPRIATE EXPANSION MATERIAL WHERE CONCRETE IS ADJACENT TO BUILDING FACE.
9. ALL EXPANSION AND ISOLATION JOINTS SHALL BE SEALED PER SPECIFICATIONS.
10. MATCH NEW PAVEMENT, CURB AND GUTTER, AND SIDEWALK INTO EXISTING. NO ABRUPT GRADE TRANSITIONS OR PONDING OF WATER WILL BE ALLOWED.
11. SAWCUT EXISTING PAVEMENT, SIDEWALK, AND CURB AND GUTTER TO NEAREST JOINT. COORDINATE REMOVAL LIMITS WITH SITE DEMOLITION CONTRACTOR AND CONSTRUCTION MANAGER.
12. ALL ITEMS NOTE NOTED AS NEW ARE EXISTING AND WERE CONSTRUCTED UNDER ORIGINAL PUD.

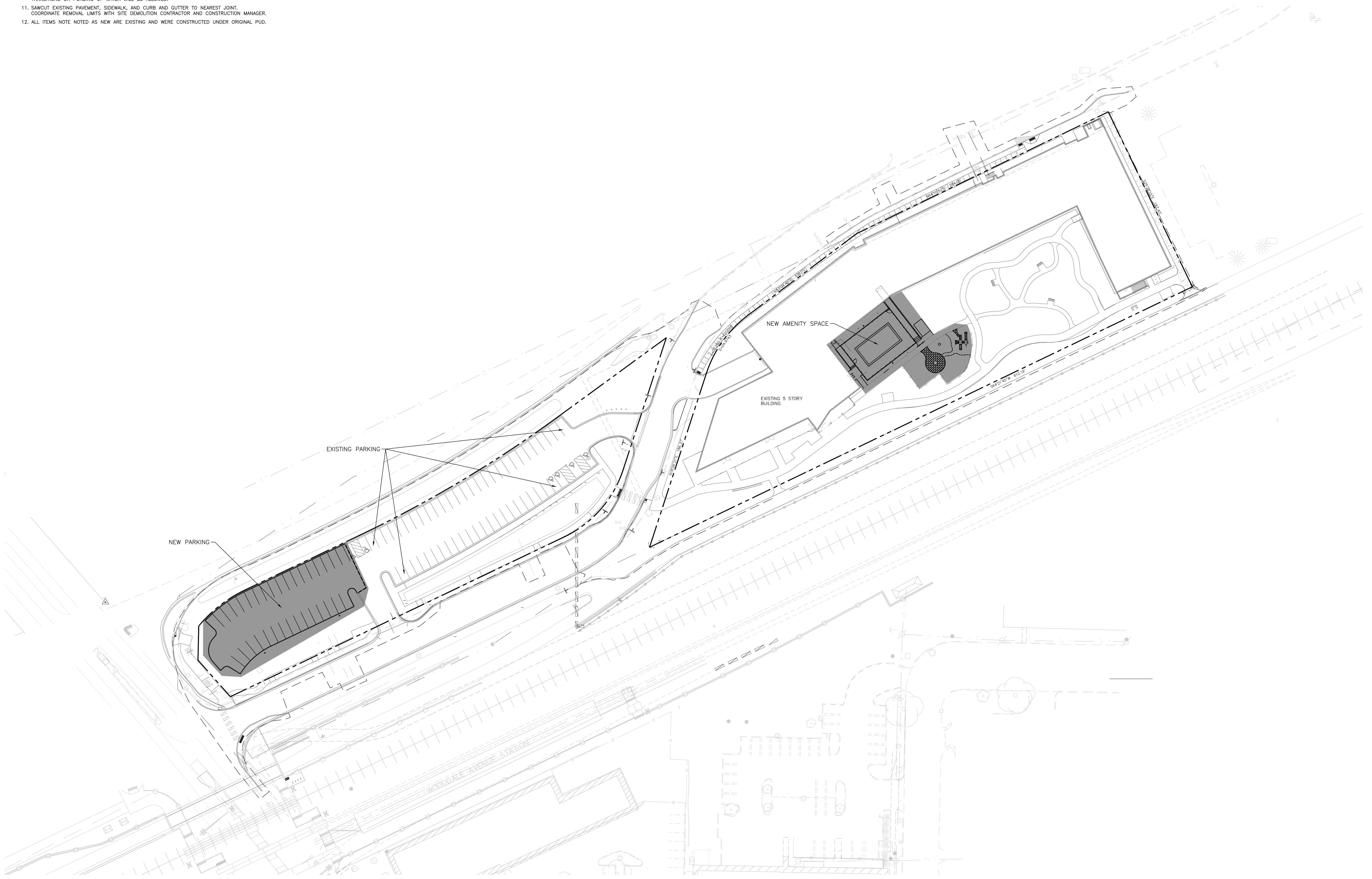

1 CIVIL SITE PLAN  
C001 1" = 40'

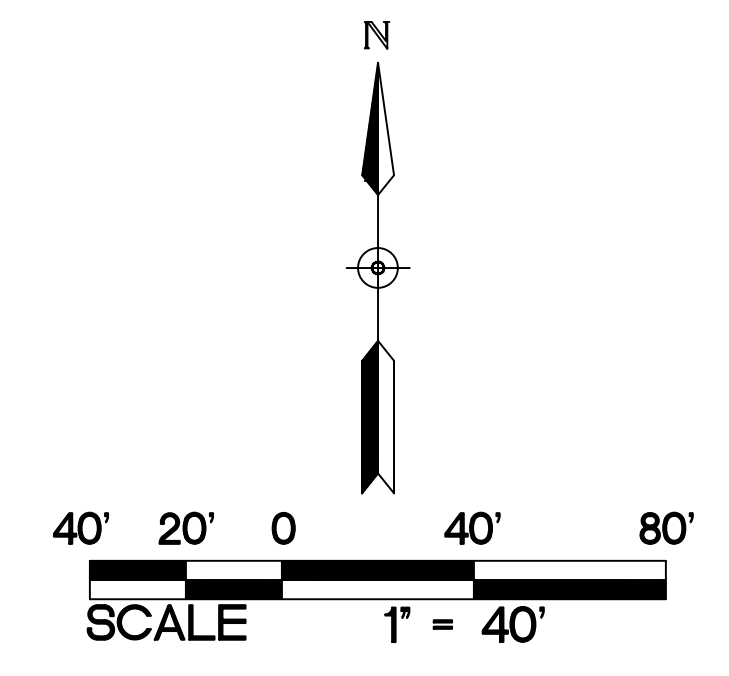

1301 American Blvd E.  
Suite 100  
Bloomington, MN 55425  
tel: (612) 879-6000  
www.kaaswilson.com

Consultant 1  
**BKBM**  
ENGINEERS  
© 2024 BKBM Engineers  
Julie Kropp Salvo & McFarlin, Inc.  
All rights reserved.  
This document is the property of BKBM Engineers and may not be used or copied without prior written consent.  
BKBM Project No. 24148.5

Project:  
**Zelia on Seven**  
5725 Minnesota 7 Services Road  
St Louis Park, MN 55416

Owner:  
Project Number 24148.5  
Date 22 January, 2024

**NOT FOR CONSTRUCTION**

Date	Revision	Rev. No.

CIVIL SITE PLAN  
1" = 40"  
**C001**