

LANDSCAPE LEGEND

- EDGER (TYP.)
- APPROXIMATE LIMITS OF SOD / IRRIGATION, SOD ALL DISTURBED AREAS (TYP.)
- ROCK MULCH (TYP.)
- SOD (TYP.)

LANDSCAPE KEYNOTES

- (A) EDGER (TYP.)
- (B) DOUBLE SHREDDED HARDWOOD MULCH (TYP.)
- (C) ROCK MULCH (TYP.)
- (D) SOD (TYP.)
- (E) MAINTENANCE STRIP (TYP.)

ABBREVIATED LANDSCAPE NOTES

1. VERIFY ALL LANDSCAPE IMPROVEMENTS WITH REMOVALS AND SITE WORK.
2. ALL DISTURBED LANDSCAPED AREAS, NOT INDICATED AS PLANTING BEDS, ARE TO BE SODDED, UNLESS NOTED OTHERWISE. SOD IS TO BE PRIMARILY KENTUCKY BLUEGRASS, FREE OF LAWN GRASS WEEDS. MATCH INTO EXISTING, AS APPLICABLE. ANCHOR SOD ON SLOPED OR POTENTIAL EROSION AREAS, OR AS REQUIRED.
3. CONTRACTOR TO VERIFY PLANTS REQUIRED AS REFLECTED ON PLAN, NOTIFY LANDSCAPE ARCHITECT IF PLAN AND SCHEDULE DO NOT MATCH. ALL PLANT MATERIAL TO ADHERE TO THE AMERICAN STANDARD FOR NURSERY STOCK, LATEST VERSION. ADD FERTILIZER, HERBACIDE, AND PESTICIDE AS NECESSARY FOR OPTIMUM GROWTH.
4. PROVIDE A MINIMUM OF 4" TOPSOIL IN LAWN AREAS AND 12" TOPSOIL IN LANDSCAPE BEDS. ADD SOIL AMENDMENTS FOR OPTIMUM PLANT GROWTH. ALL PARKING ISLAND GRADES SHALL HAVE A SIGNIFICANT CROWN.
5. EDGING TO BE COMMERCIAL-GRADE COOL-MET (OR EQUAL) STEEL EDGING, 3/16" THICK X 5" TALL, COLOR BLACK, OR SPADED EDGE, AS INDICATED. STEEL EDGING SHALL BE PLACED WITH SMOOTH CURVES AND STAKED WITH METAL SPIKES NO GREATER THAN 4 FOOT ON CENTER WITH TOP OF EDGER AT GRADE, FOR MOWERS TO CUT ABOVE WITHOUT DAMAGE. UTILIZE CURBS AND SIDEWALKS FOR EDGING WHERE POSSIBLE. WHERE EDGING TERMINATES AT A SIDEWALK, BEVEL OR RECESS ENDS TO PREVENT TRIP HAZARD. SPADED EDGE TO PROVIDE V-SHAPED DEPTH AND WIDTH TO CREATE SEPARATION BETWEEN MULCH AND GRASS. INDIVIDUAL TREE, SHRUB, OR RAIN-GARDEN BEDS TO BE SPADED EDGE, UNLESS NOTED OTHERWISE. EDGING TO MATCH EXISTING CONDITIONS (WHERE APPLICABLE).
6. DOUBLE SHREDDED HARDWOOD MULCH SHALL BE NATURAL IN COLOR, OR APPROVED EQUAL, AND AT A MINIMUM 4" DEPTH, FREE OF ALL DELETERIOUS MATERIAL. ROCK MULCH TO BE RIVER ROCK, 1 1/2" - 3" DIAMETER, AND AT A MINIMUM 3" DEPTH. ROCK MULCH TO BE ON COMMERCIAL GRADE LANDSCAPE FILTER FABRIC, WITH 4" OVERLAP AND ANCHORED. OWNER TO APPROVE OF MULCH.
7. SINGLE TREE AND SHRUB PLANTINGS SHALL HAVE A 4" DEPTH SHREDDED HARDWOOD MULCH RING AROUND EACH BASE. DECIDUOUS PLANT MATERIAL SHALL HAVE A MINIMUM 3" DIAMETER RING, EVERGREEN PLANT MATERIAL SHALL HAVE A RING TO THE DRIP LINE.
8. EXISTING TREES AND SHRUBS, THROUGHOUT THE PROPERTY, SHALL BE PRUNED TO REMOVE DEAD OR UNDESIRABLE LIMBS AND TO SHAPE PLANT FOR DESIRABLE APPEARANCE AND COMPLETED BY A QUALIFIED INDIVIDUAL. CONTRACTOR TO CLEAR AND GRUB EXISTING VEGETATION AND DISPOSE OF ALL REMOVALS OFF-SITE PER PROJECT IMPROVEMENTS.
9. CONTRACTOR TO WATER PLANT MATERIAL DURING INSTALLATION AND DURING ESTABLISHMENT PERIOD. VOLUME OF WATER TO BE PER PLANT REQUIREMENT FOR ESTABLISHMENT AND NORMAL GROWTH.
10. CONTRACTOR TO WARRANTY NEW PLANT MATERIAL FOR ONE-YEAR UPON PROJECT COMPLETION AND OWNER'S ACCEPTANCE.
11. PROPERTY SHALL HAVE AUTOMATIC UNDERGROUND IRRIGATION SYSTEM. ALL LANDSCAPE AREAS TO BE IRRIGATED. CONTRACTOR TO PROVIDE SHOP DRAWINGS FOR LANDSCAPE ARCHITECT APPROVAL. SYSTEM SHALL BE WINTERIZED/BLOWN OUT AFTER THE FIRST OPERATIONAL SEASON AND SHALL PROVIDE STARTUP THE FOLLOWING SPRING. IRRIGATION SHALL HAVE TWO-YEAR WARRANTY ON PARTS AND LABOR FOLLOWING INSTALLATION APPROVAL BY OWNER. PROVIDE BACKFLOW DEVICE, WATER METER, BOOSTER PUMP, CONTROLLER, RAIN SENSOR, WIRES, VALVE BOXES, SLEEVING, VALVES, ROTORS, SPRAYS, AND OTHER ACCESSORIES FOR A COMPLETE SYSTEM.

PLANT SCHEDULE

SYMBOL	CODE	QTY	BOTANICAL NAME	COMMON NAME	CONT	SPACING
PERENNIALS						
	CVR	41	VERONICASTRUM VIRGINICUM	CULVER'S ROOT	#1 CONT.	24" O.C.
	FAS	39	ASTILBE X ARENSII 'FANAL'	FANAL ASTILBE	#1 CONT.	18" O.C.
	FRN	25	MATTEUCCIA STRUTHIOPTERIS	OSTRICH FERN	#1 CONT.	30" O.C.
	PDS	13	SPOROBOLUS HETEROLEPIS	PRAIRIE DROPSEED	#1 CONT.	24" O.C.
	PNS	74	CAREX PENNSYLVANICA	PENNSYLVANIA SEDGE	#1 CONT.	16" O.C.
	RBC	24	ECHINACEA PURPUREA 'RUBY STAR'	RUBY STAR CONEFLOWER	#1 CONT.	20" O.C.

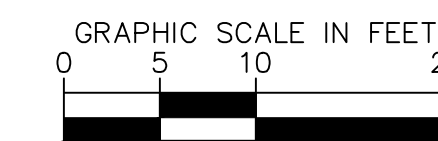
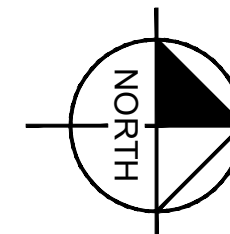

Know what's below.
Call before you dig.

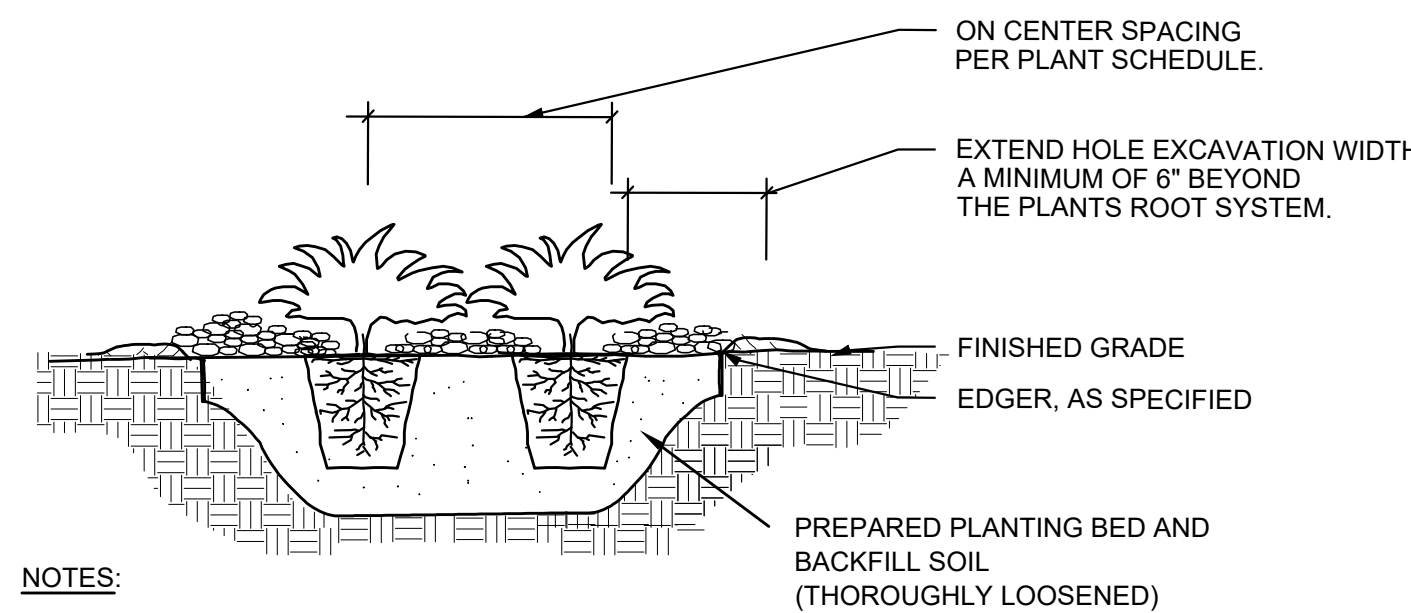

- NOTES:**
1. SCARIFY SIDES AND BOTTOM OF HOLE.
 2. PROCEED WITH CORRECTIVE PRUNING OF TOP AND ROOT.
 3. REMOVE CONTAINER AND SCORE OUTSIDE OF SOIL MASS TO REDIRECT AND PREVENT CIRCLING FIBROUS ROOTS. REMOVE OR CORRECT STEM GIRDLING ROOTS.
 4. PLUMB AND BACKFILL WITH PLANTING SOIL.
 5. WATER THOROUGHLY WITHIN 2 HOURS TO SETTLE PLANTS AND FILL VOIDS.
 6. BACK FILL VOIDS AND WATER SECOND TIME.
 7. PLACE MULCH WITHIN 48 HOURS OF THE SECOND WATERING UNLESS SOIL MOISTURE IS EXCESSIVE.
 8. MIX IN 3-4" OF ORGANIC COMPOST.

1 SHRUB / PERENNIAL PLANTING DETAIL
SCALE: N.T.S. L100

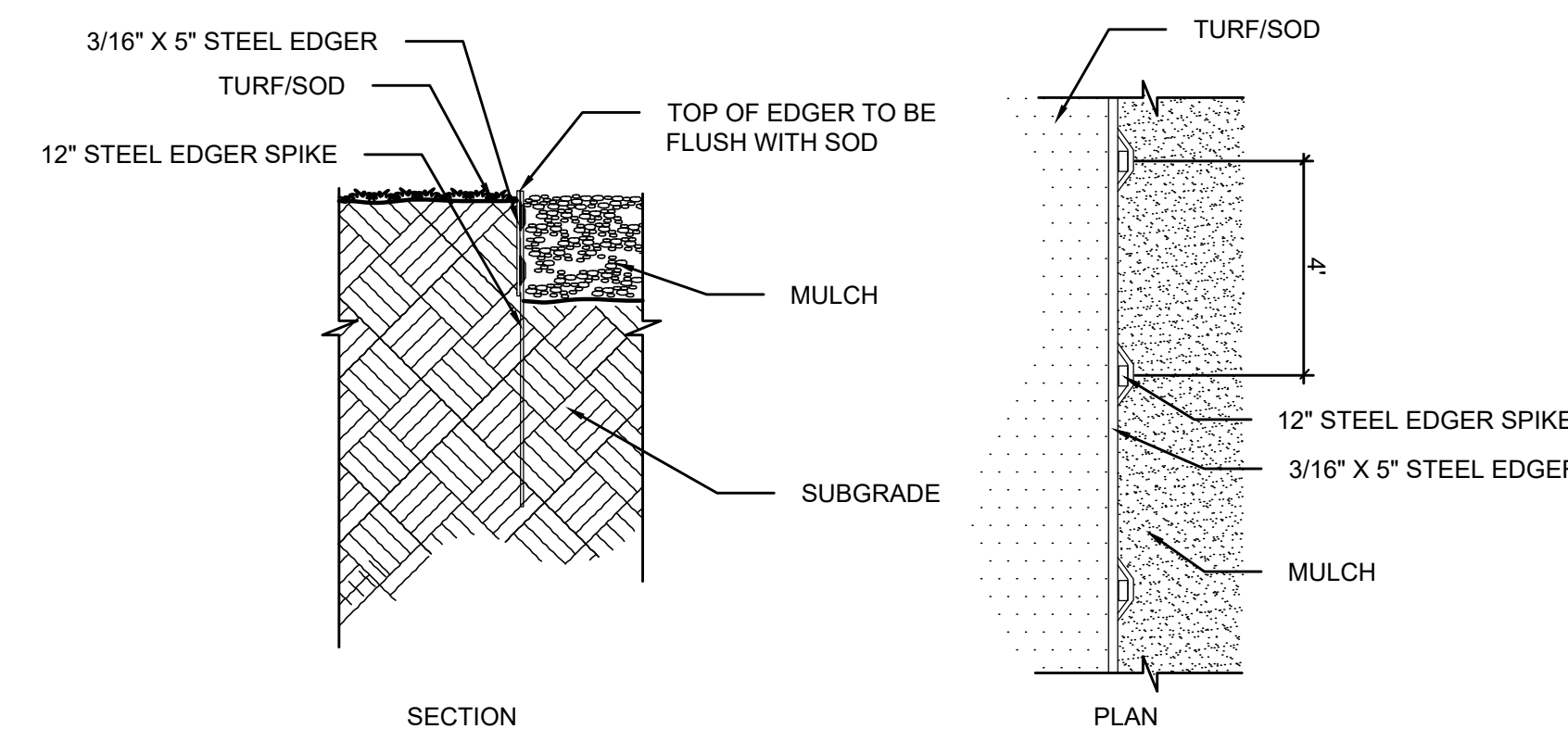

2 STEEL EDGER DETAIL
SCALE: N.T.S. L100

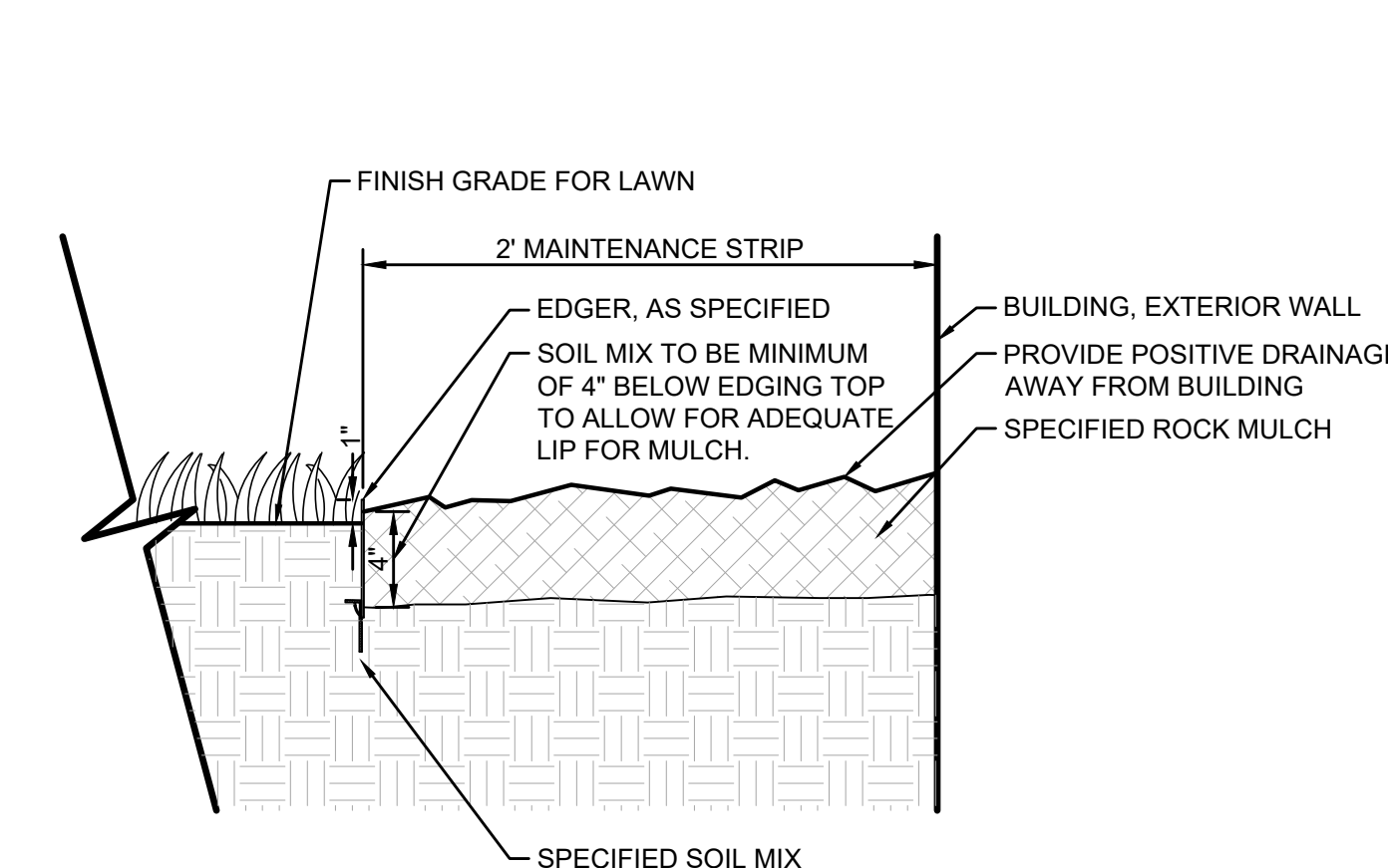

3 MAINTENANCE STRIP DETAIL
SCALE: 1-1/2"=1' L100

ISSUED FOR PERMIT - NOT FOR CONSTRUCTION

ISSUES & REVISIONS	DATE
PERMIT SET	12/8/2023
CUP APPLICATION	02-05-2024

I HEREBY CERTIFY THAT THIS PLAN, SPECIFICATION OR REPORT WAS PREPARED BY ME OR UNDER MY DIRECT SUPERVISION AND THAT I AM A DULY LICENSED PROFESSIONAL LANDSCAPE ARCHITECT UNDER THE LAWS OF

NOT FOR CONSTRUCTION
MITCHELL COOKAS, PLA

DATE: 12/8/2023 LIC. NO. 56522

DRAWN BY: CFK
CHECKED BY: MGC

LANDSCAPE PLAN AND DETAILS

C400